



# product release

NPR-18

from

**GUNDLACH**

## No. 825 Heavy Duty Undercut Saw Kit

**PRICE**  
**\$289<sup>95</sup>**

### New and improved version of the No. 820\* Saw

This powerful saw undercuts walls, door jambs, doors, inside corners and most toe spaces. The 6½" diameter No. 821 Carbide Tipped Steel Blade can fully undercut most doors in place and when used with the No. 805 Masonry Blade, can also be used for undercutting hearths. Height of cut is easily adjustable from flush to 1" above the floor with ¼" graduations. The large height adjuster base helps prevent tipping and assures accurate, level cutting. Has a dual angle depth gauge which allows undercutting at a 'straight on' or 45° angle. Depth gauge is graduated in ⅛" increments with a 1½" maximum depth of cut. Each Saw Kit includes Nos. 805 Masonry Blade, 821 Carbide Tipped Steel Blade, saw, plastic carrying case, wrench for blade removal, extra set of motor brushes and instructions. Guaranteed for one year.

**Caution:** Depth of undercut should not exceed wallboard thickness (generally ½") to avoid structural weakening caused by cutting nails, wall studs or sill plates, and to avoid blade damage by hitting nails.

### Improved features include:

- Wider, cushioned cast aluminum handle that can be locked in three 'full grip' positions for better saw control
- Cutting height adjustment is now done with two 3-arm knob screws and the setting can then be positively locked at the desired height by tightening two wing screws
- Lower RPM motor (6,500 vs. 8,000) is more powerful and helps minimize airborne dust
- A dust port for 1¼" vacuum hose is provided in the height adjuster base (This feature had already been included in the latest No. 820 Saws)

| Saw Specifications    |                  |
|-----------------------|------------------|
| Motor                 | 120V 8.15A 60 Hz |
| Blade Shaft RPM       | 6,500 RPM        |
| Weight (with No. 821) | 10¾ lbs.         |



U.S. Patent No. 5,974,674

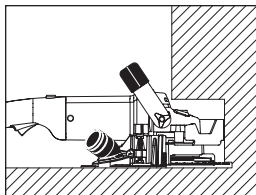

Toe Space Area Undercutting

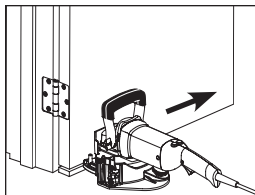

Door Undercutting

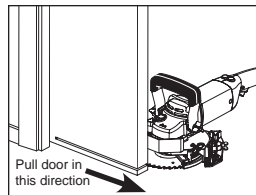

Pocket Door Undercutting

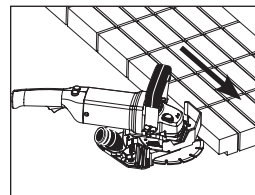

Masonry Undercutting

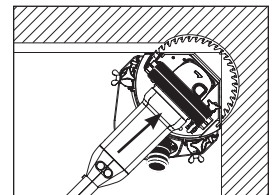

Inside Corner Undercutting

| Blades for Nos. 820* and 825 Undercut Saws |                          |              |          |
|--|--------------------------|--------------|----------|
| Item No.                                   | Blade Type (bell-shaped) | No. of Teeth | Diameter |
| 805  | Masonry                  | —            | 6½"      |
| 821  | Carbide Tipped Steel     | 36           | 6½"      |
| 822  | Segmented Diamond Rim    | —            | 6½"      |

**Caution:** As these blades are subject to possible abuse, they are not guaranteed. Blades are **not** recommended for cutting metal as sparks can cause a fire hazard.

\* The No. 825 Undercut Saw Kit replaces the discontinued No. 820.

No. 805  For dry undercutting masonry.

**PRICE**  
**\$11<sup>75</sup>**

No. 821  U.S. Patent Pending For undercutting wood. Carbide tipped for long life.

**PRICE**  
**\$30<sup>25</sup>**

No. 822  For dry undercutting tile, stone, concrete and brick. (Sold separately.)

**PRICE**  
**\$46<sup>16</sup>**



**Beno J. Gundlach Company**  
211 North 21st Street • P.O. Box 544  
Belleville, IL 62222 • U.S.A.  
TEL: 618 233-1781 • FAX: 618 233-3636  
www.benogundlachco.com